

version with featherkey

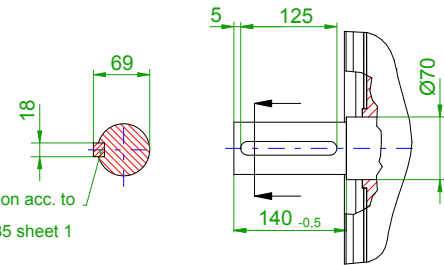

deviation acc. to
DIN 6885 sheet 1

- WA - Shaft extension 65m6 x 140-0,5 to DIN748, tapped centre hole DR M20 to DIN332
- XA - Relief groove E1.6x0.3 to DIN 509
- WI - Water inlet temperature 30°C
- W - Water flux 12 l/min
- K - Terminal box
- PG - Cable entry 2x M50x1,5
- PG2 - SMI Module
- E - Ground clamp
- H - Lifting eye
- S - Greasing nipple

Type of protection: IP 55

Type of construction: IM B35 with flange A450 (V35)

Einheit / unit: mm	Asynchron-Servomotor Asynchronous Servo Motor: 1PH8186-1DD23-2DD1-Z
nicht tolerierte Maße / not toleranced dimensions:	Optionen / options: K40 +K90
Maßstab / scale: ohne / without	Gewicht / mass: 430 kg
CAD CREATOR 1.8 (WWW-Version V01.08.00.00)	Bemerkung / notice:
	Druckdatum / print date: 02.02.2012