

Spindel, Schaltkreuz, Anlaufscheibe vor der Montage mit Antirutschschutzmittel behandeln.

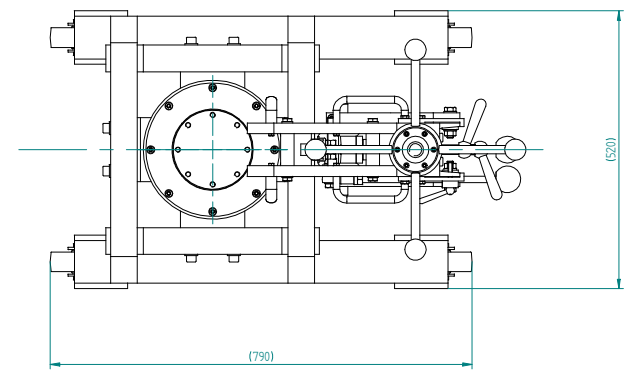
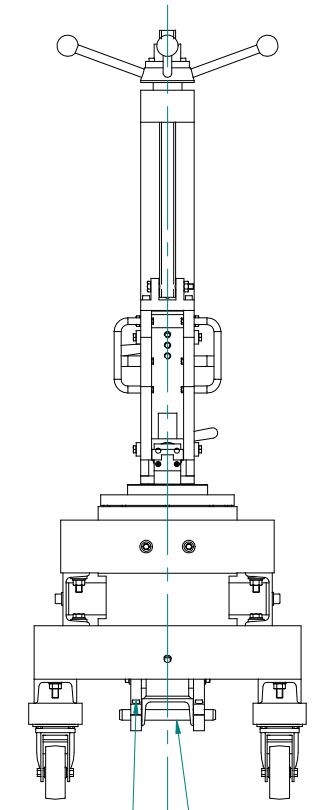
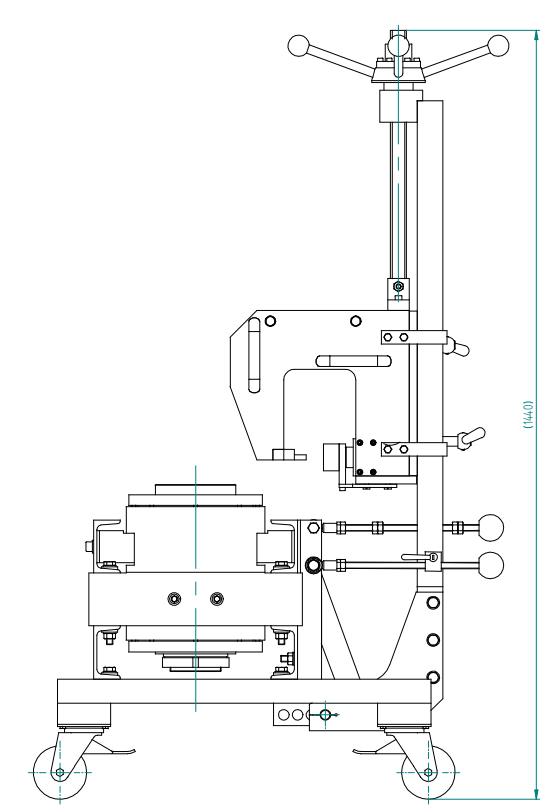
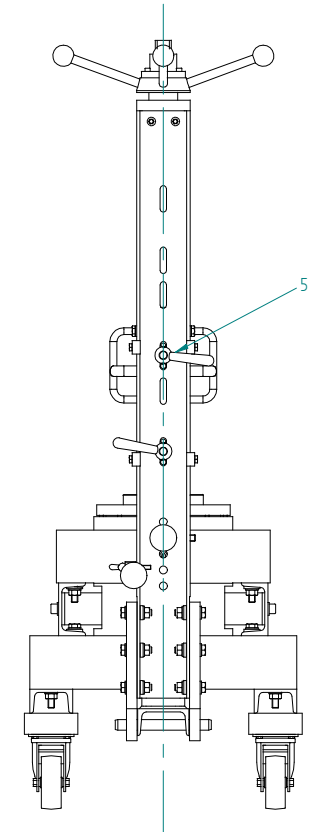
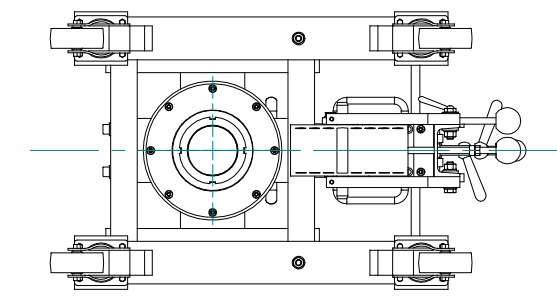

Anzugmomente für Schrauben und Müttern
 soweit nicht extra angegeben
 M5-8.8: 6Nm
 M6-8.8: 9Nm
 M8-8.8: 16Nm
 M10-8.8: 26Nm
 M12-8.8: 85Nm