

## Simulation with visualization problems

CATIA V5 is in comparison to other CAD/CAM Software not able to display NC simulation in a proper way.

The video result shows a wavy surface:

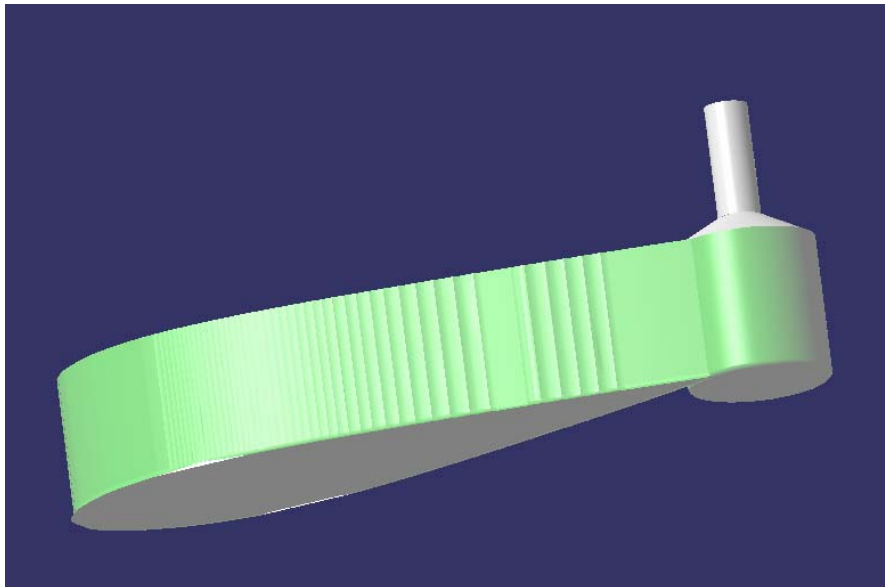

Video Result

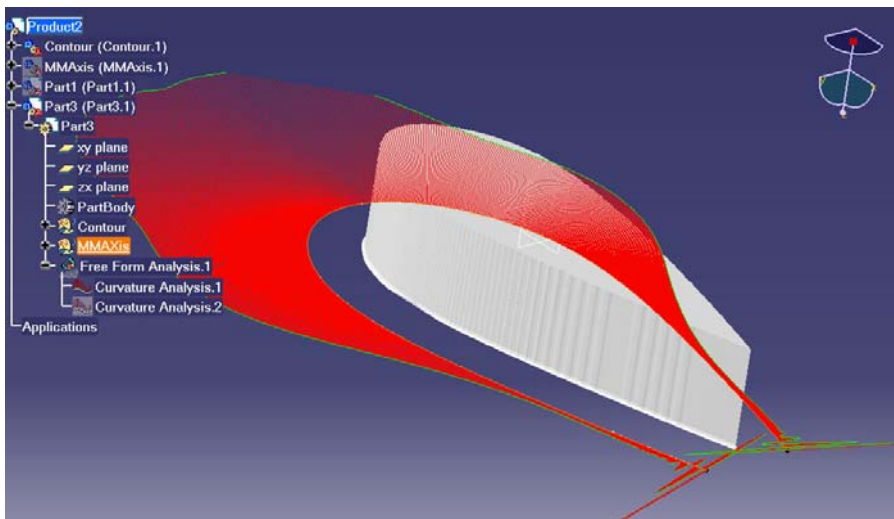

Cgr output

NC Path is correct not wavy. Red Curvature analysis belongs to imported Apt-Points.

## Part for NC Test:

Create Sketch usind Sketch Spline

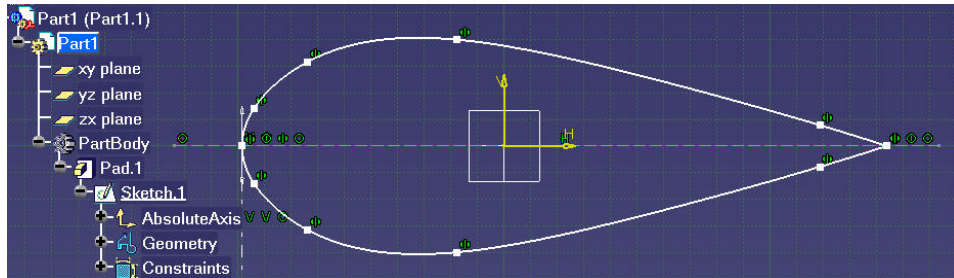

Use sketch for single Pad

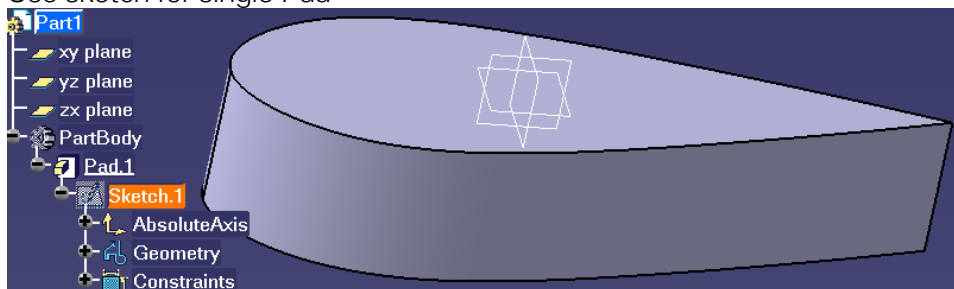

## Create NC Operation

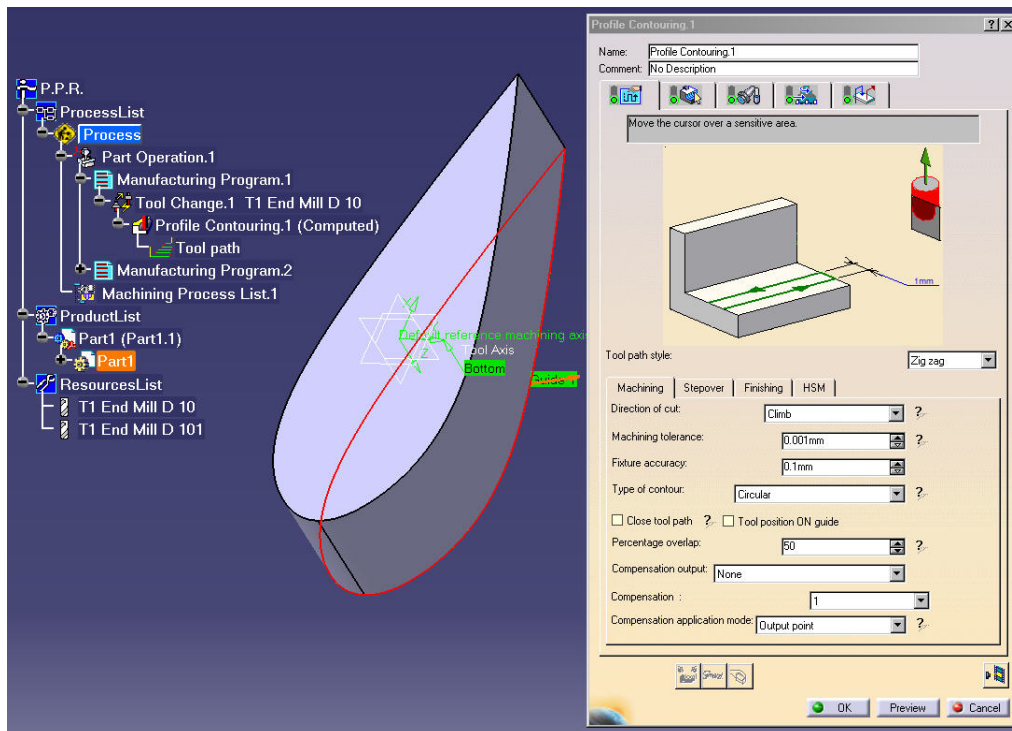

## Tools Options Settings:

General	Resources	Operation	Output	Program	Photo/Video
<b>Simulation at</b>					
<input checked="" type="radio"/> Program level <input type="radio"/> Part operation level					
<b>Video</b>					
<input type="checkbox"/> Stop at tool change					
Collisions detection : <input checked="" type="radio"/> Ignore <input type="radio"/> Stop <input type="radio"/> Continue					
<input checked="" type="checkbox"/> Touch is Collision					
<input type="checkbox"/> Multiple Video result on program					
<b>Photo</b>					
Fault box: <input checked="" type="radio"/> Wireframe <input type="radio"/> Transparent <input type="radio"/> None					
<input type="checkbox"/> Compute all information at picked point					
<b>Performance</b>					
<input checked="" type="checkbox"/> Tool and faceting <input type="radio"/> Smaller <input checked="" type="radio"/> Larger <input type="radio"/> Standard					
Photo resolution <input type="text" value="0"/>					
<input checked="" type="checkbox"/> Tool axis interpolation angle (5 axis only) <input type="text" value="0.1deg"/>					
<input checked="" type="checkbox"/> Optimized rendering for Video					
<b>Color</b>					
Tool and machined area: <input type="radio"/> Same <input type="radio"/> Last tool different <input checked="" type="radio"/> All different					
Tool1 <input type="text" value=""/>					
Tool holders <input type="text" value=""/>					
Parts <input type="text" value=""/>					
Fixtures <input type="text" value=""/>					

OK Cancel