

Strukturspannung, berechnet als Hot-Spot

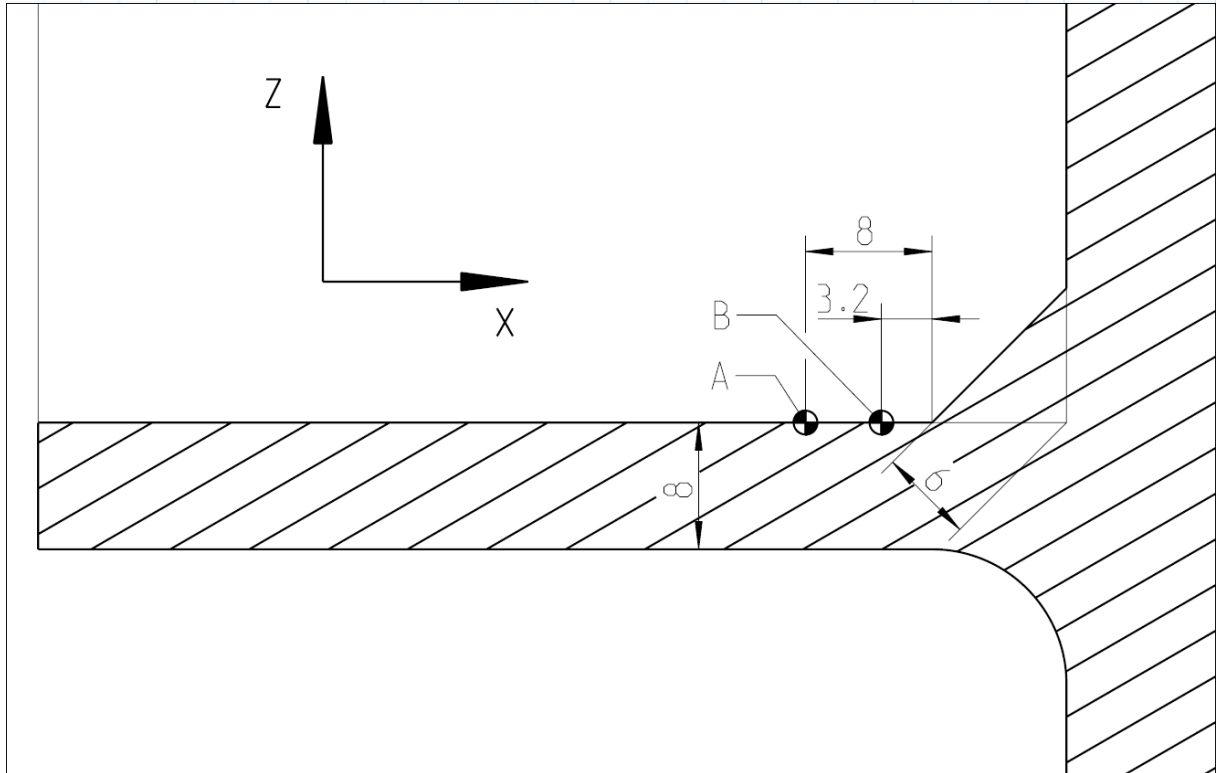

$$\sigma_{x_A} := 84.6 \text{ MPa}$$

$$\sigma_{x_B} := 89.6 \text{ MPa}$$

$$\sigma_{x_{\text{hotspot}}} := \frac{\sigma_{x_B} - 0.4 \cdot \sigma_{x_A}}{0.6} = 92.9 \text{ MPa}$$

$$\sigma_{x_{CAB}} := 105.4 \text{ MPa}$$

$$\frac{\sigma_{x_{CAB}}}{\sigma_{x_{\text{hotspot}}}} = 113.4\%$$