

8250 MIT SEITLICHER VERSPANNUNG

8250 WITH SIDE GUIDE

-3-

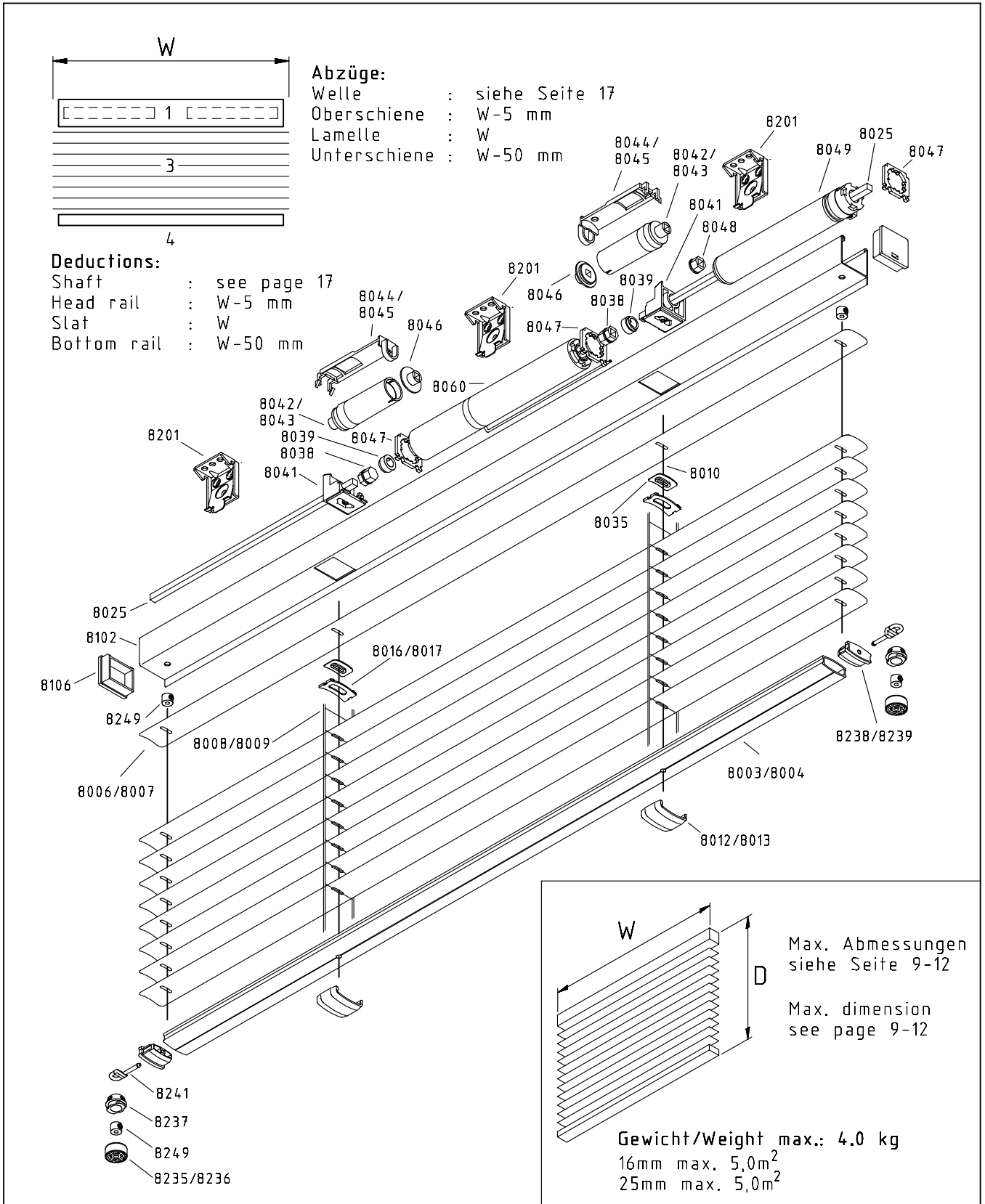

STUECKLISTE
PART LIST

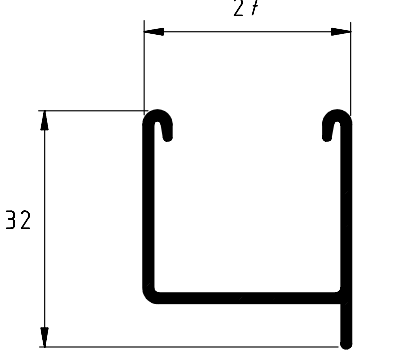
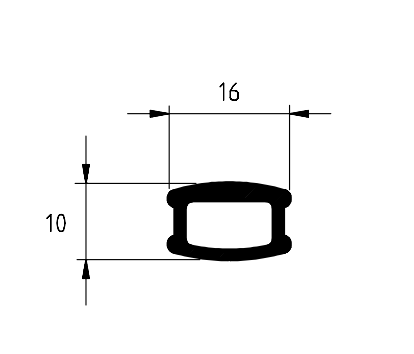
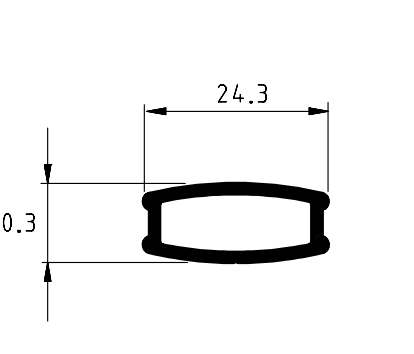
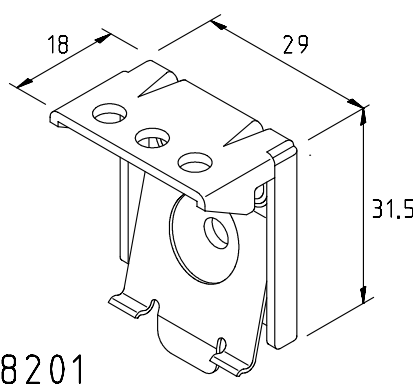
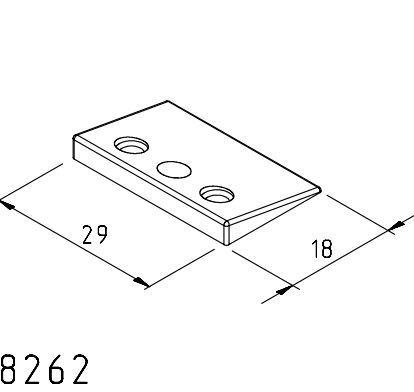
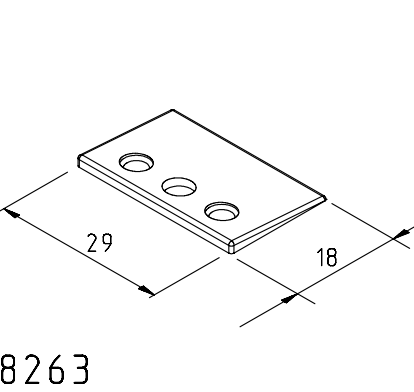
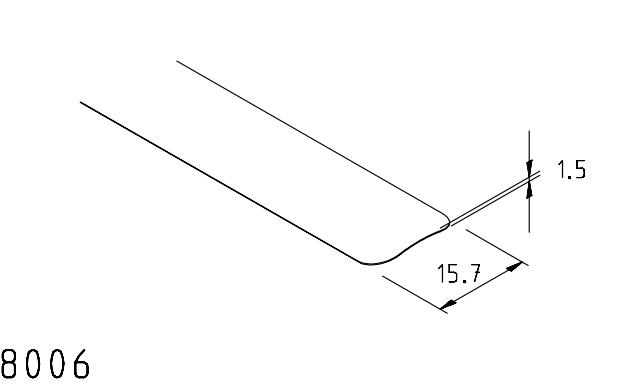
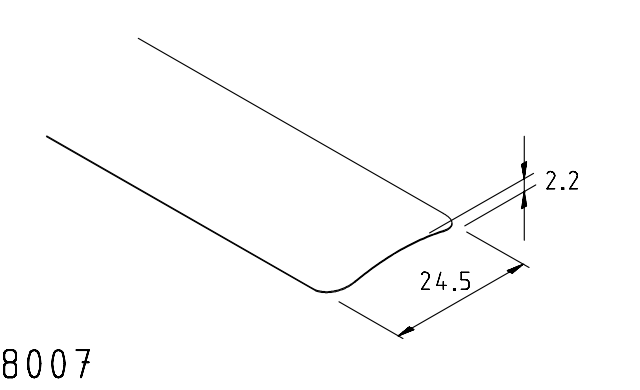
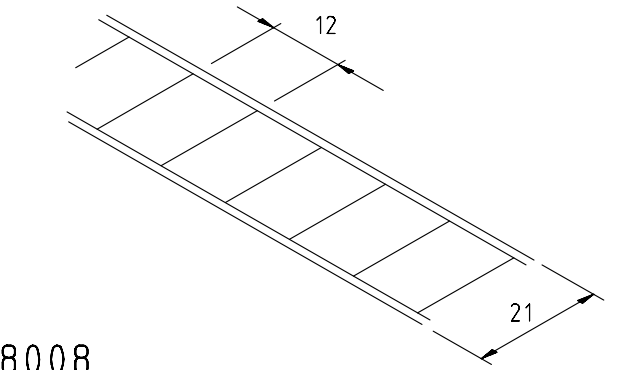
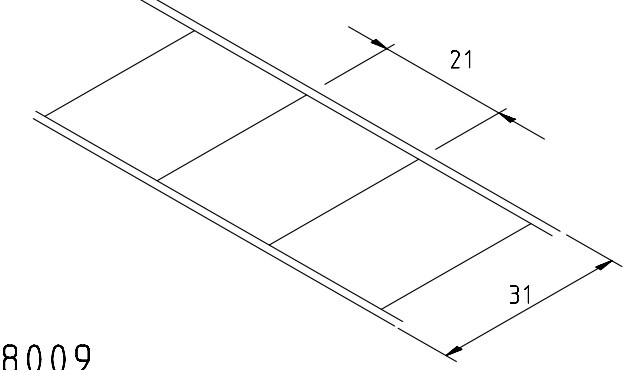
 <p>8102</p>	 <p>8003</p>	 <p>8004</p>
 <p>8201</p>	 <p>8262</p>	 <p>8263</p>
 <p>8006</p>	 <p>8007</p>	
 <p>8008</p>	 <p>8009</p>	

ZUSAMMENBAU ASSEMBLING

-22-

1

Stege sauber abschneiden
Cut connections clear

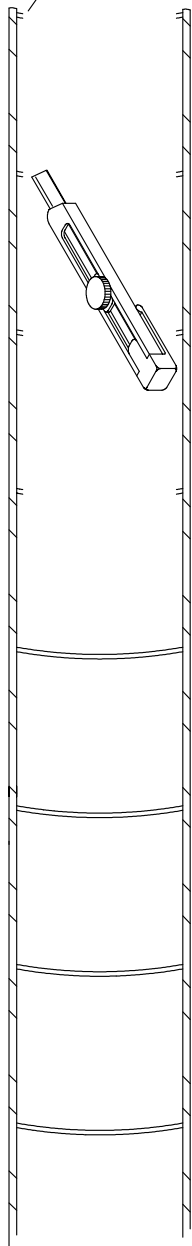

Die Schlaufenlänge L ist je nach Leiterkordel zu bestimmen (ca. 82mm)

The loop length L is to be determined according to the type of ladder cord (about 82mm)

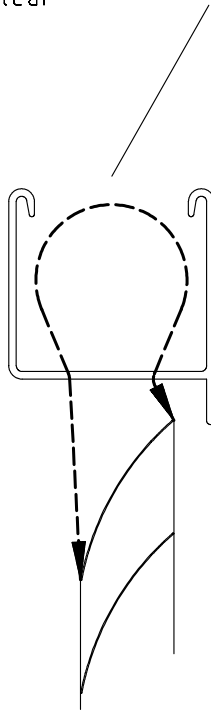

Schlaufenlänge L
Loop length L
(Slat 25mm: ca. 82mm)
(Slat 16mm: ca. 68mm)

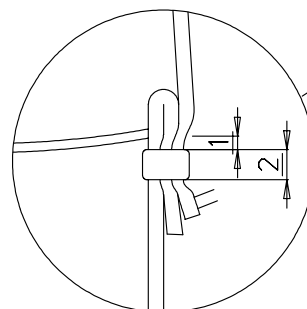
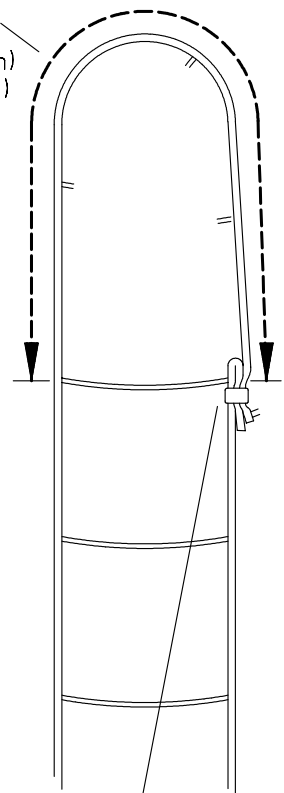
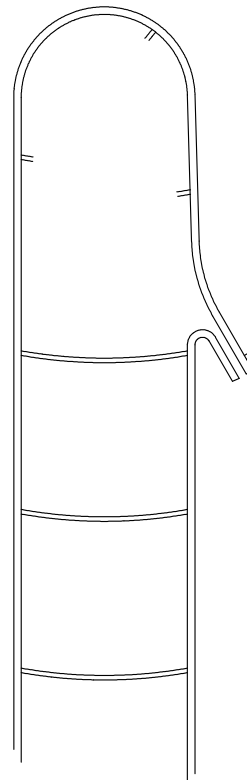

Stahlband
Splice belt

ZUSAMMENBAU
ASSEMBLING

-23-

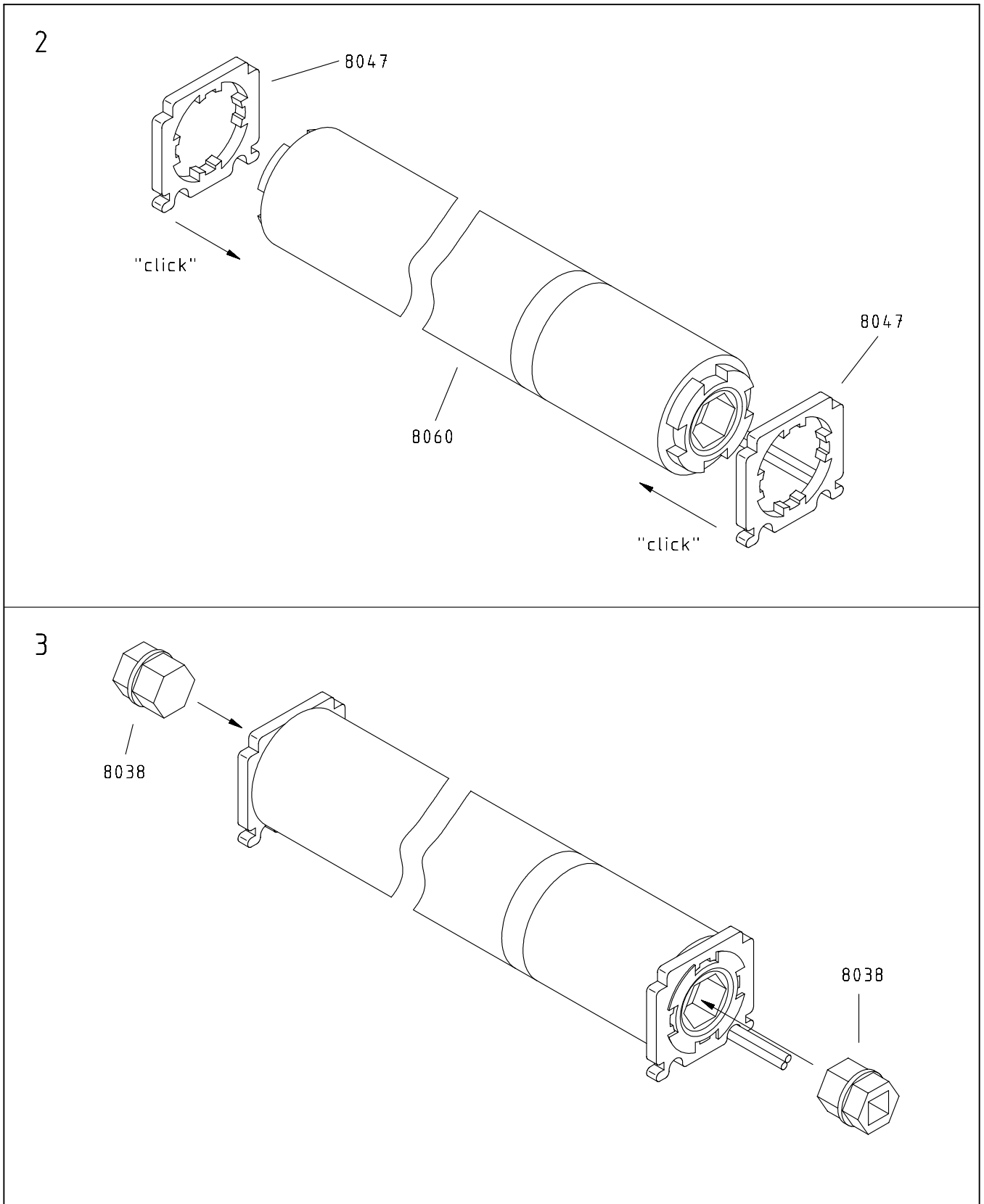

ZUSAMMENBAU
ASSEMBLING

-25-

6

1.

Festen Doppelknoten machen.

Make a solid double-knot.

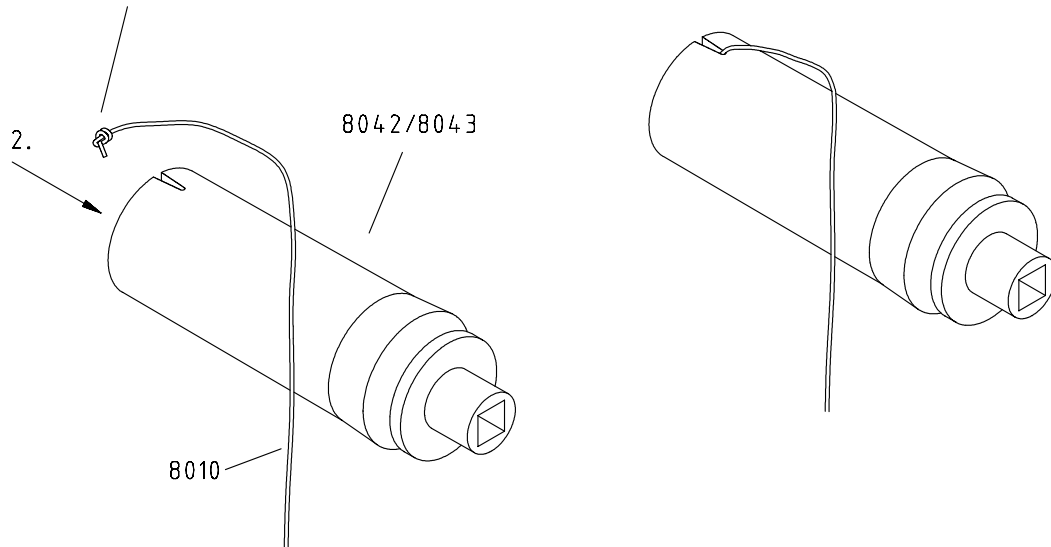

7

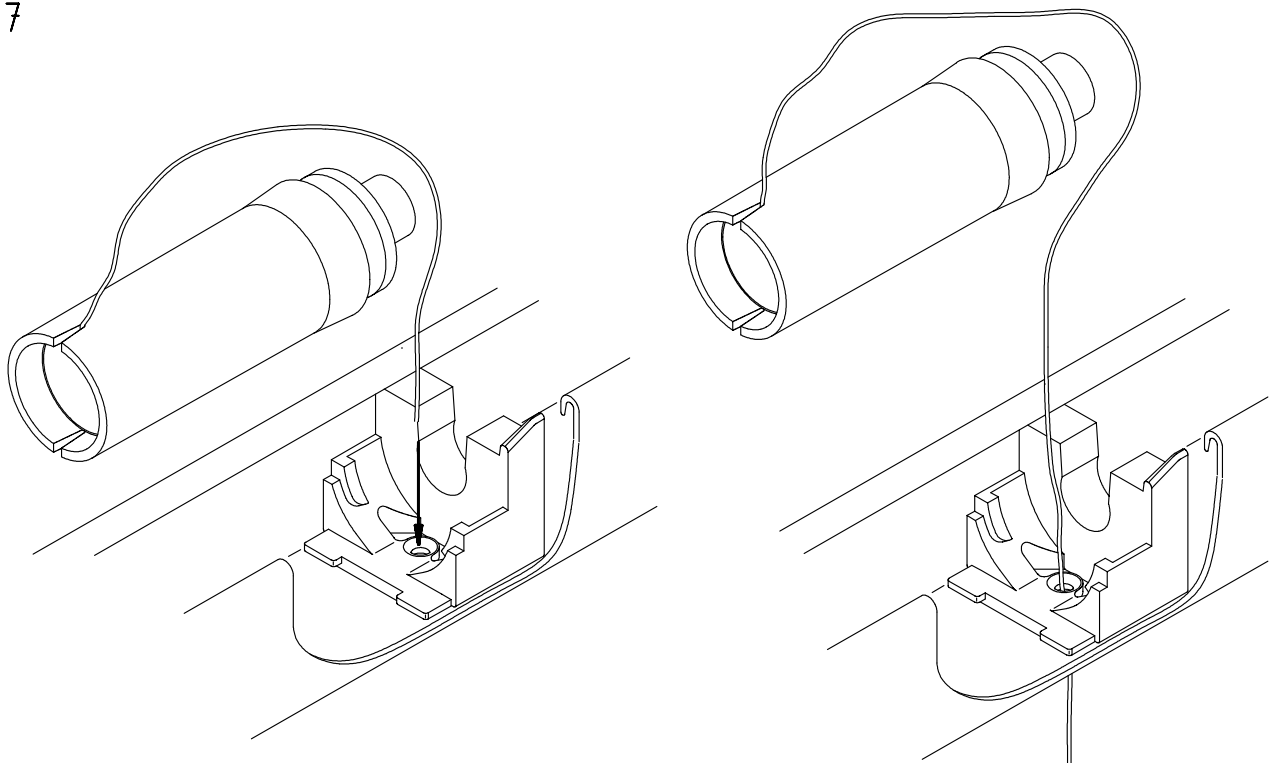

ZUSAMMENBAU
ASSEMBLING

-26-

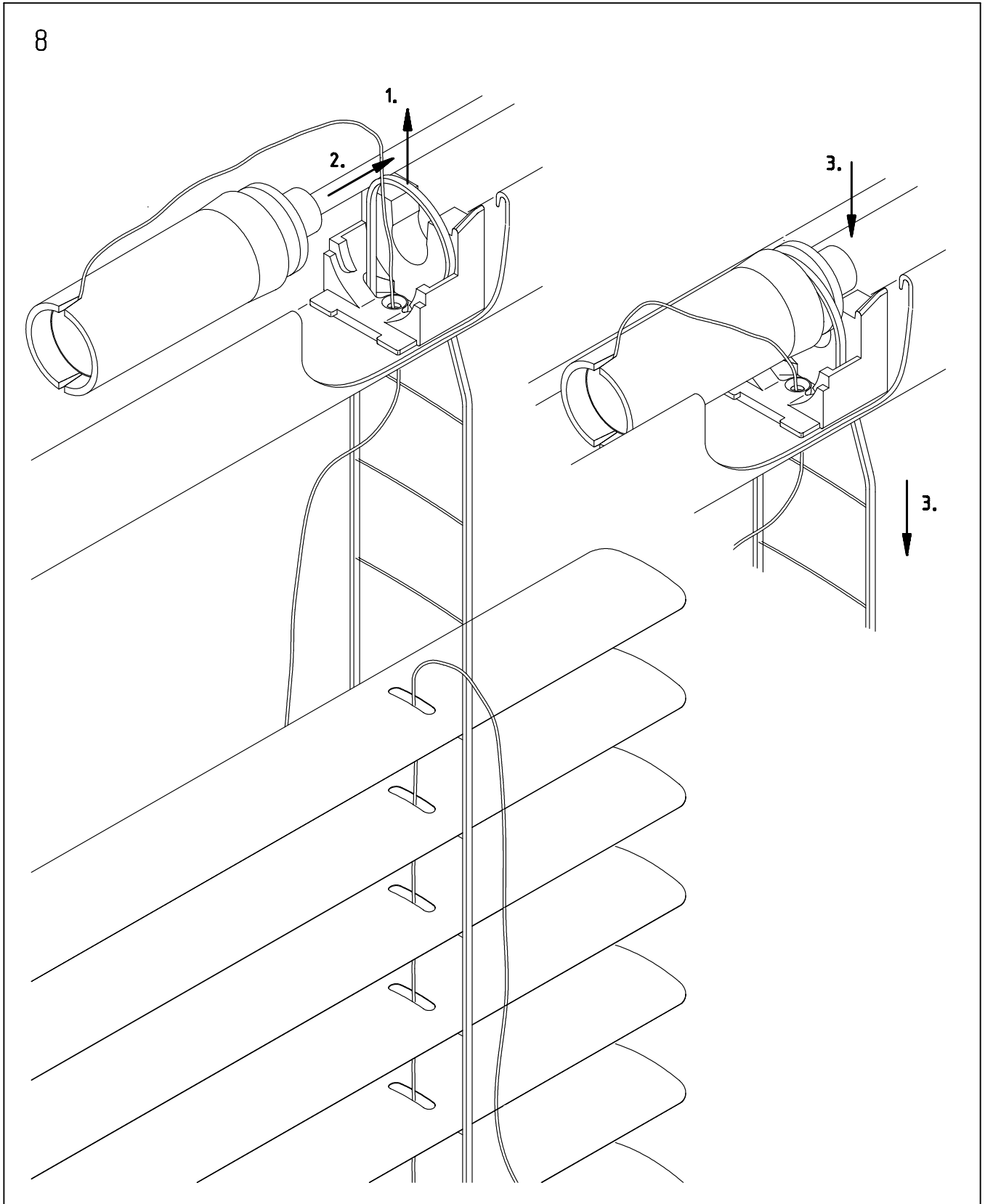

ZUSAMMENBAU
ASSEMBLING

-27-

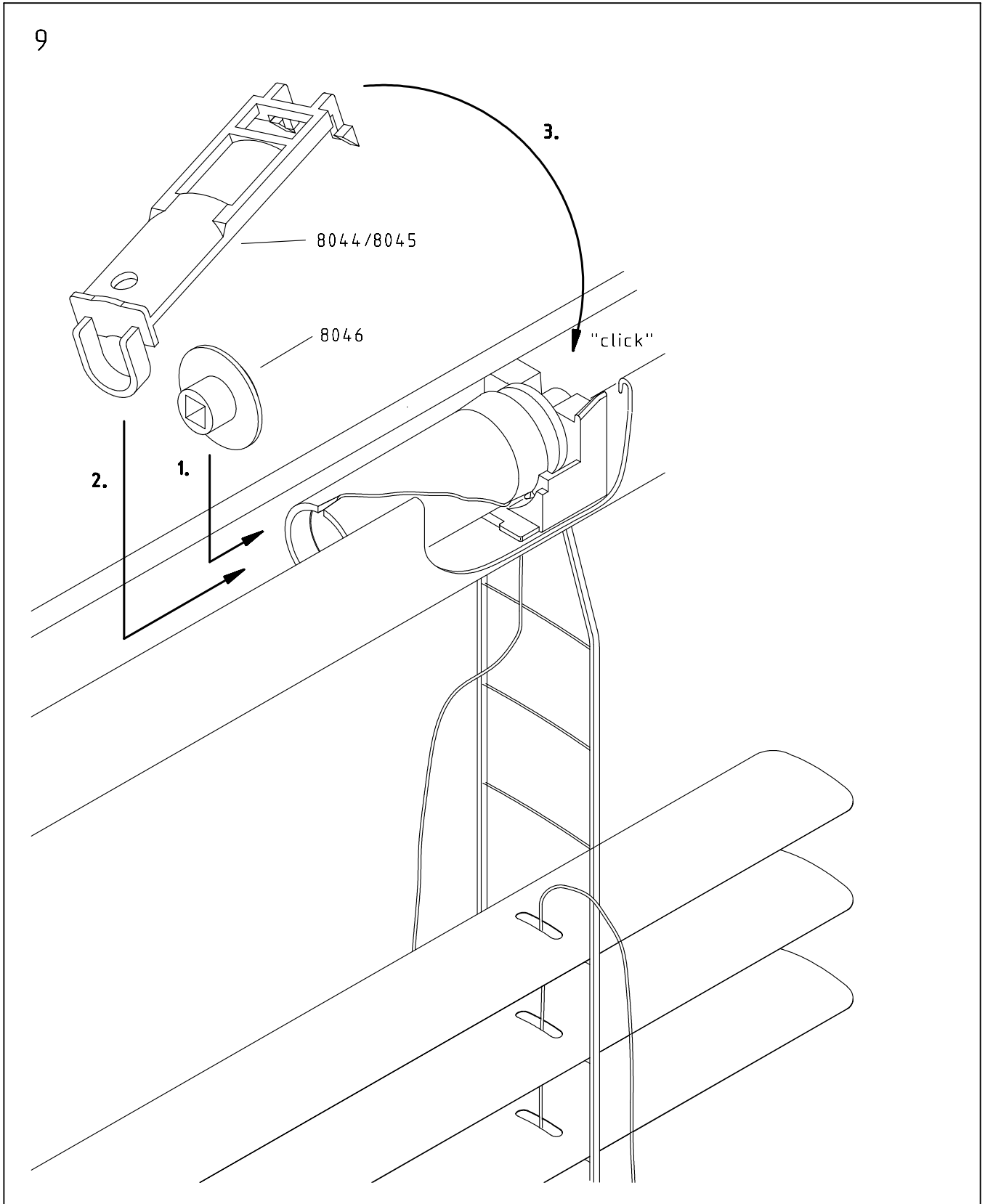

ZUSAMMENBAU SEITLICH VERSPANNT
ASSEMBLING WITH SIDE GUIDE

-38-

22

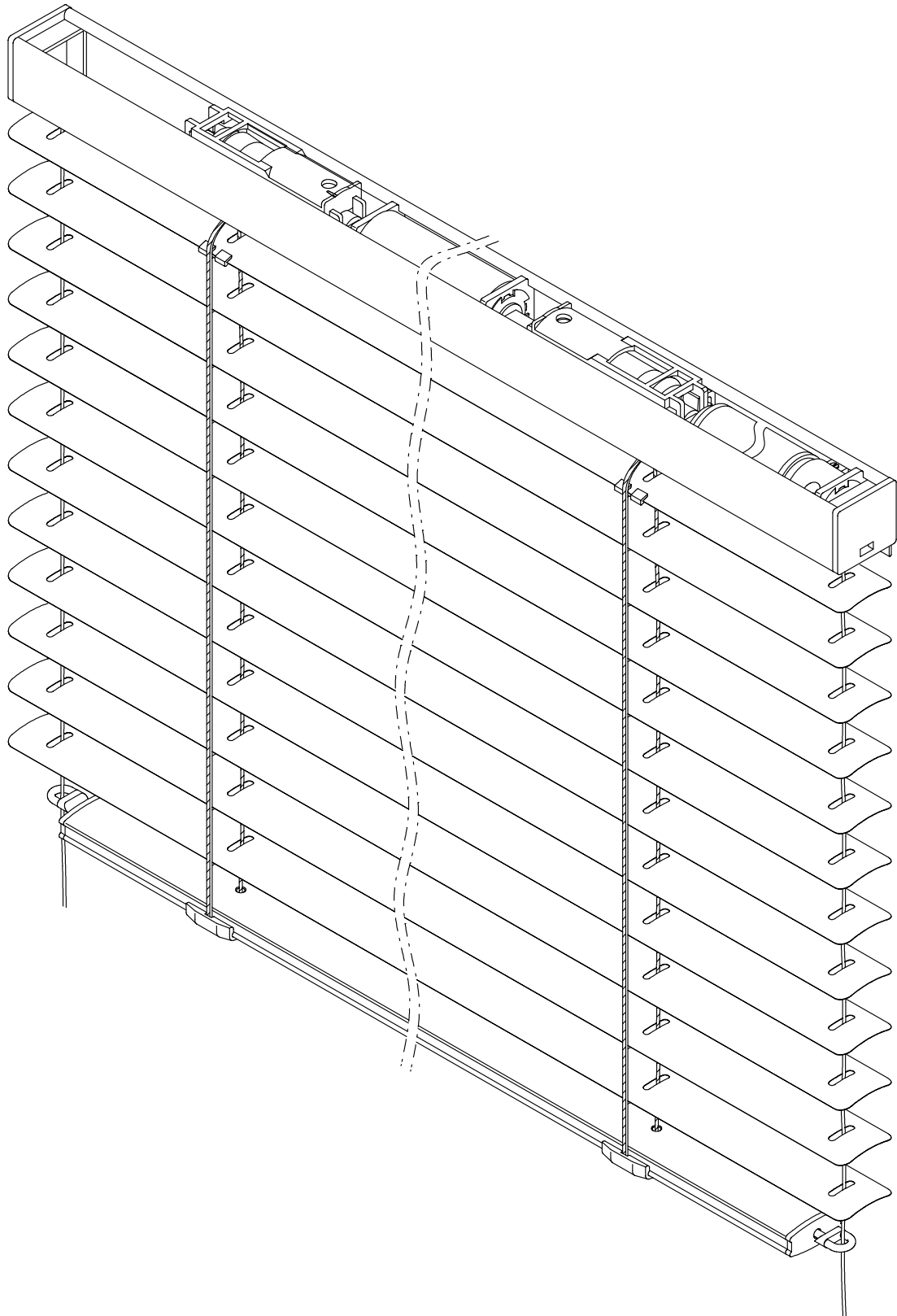

MONTAGE IM OBJEKT
FITTING ON SITE

-39-

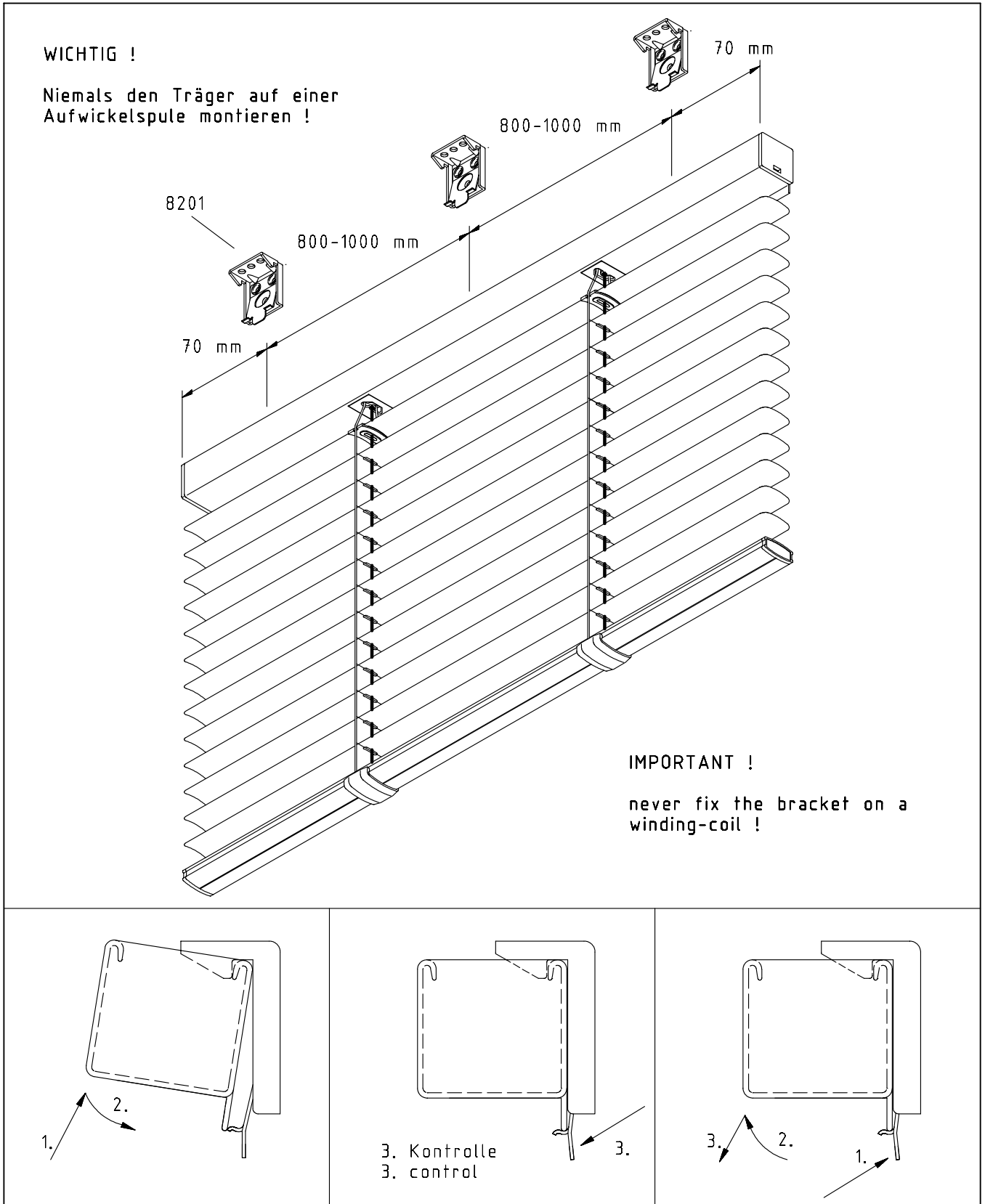

MONTAGE IM OBJEKT
FITTING ON SITE

-41-

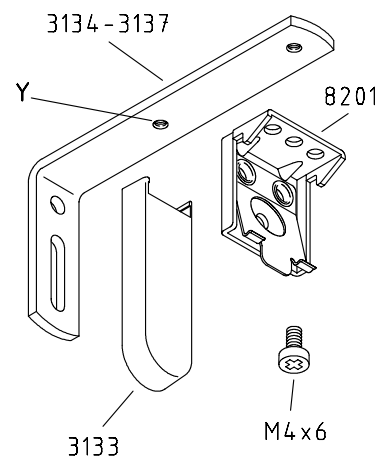
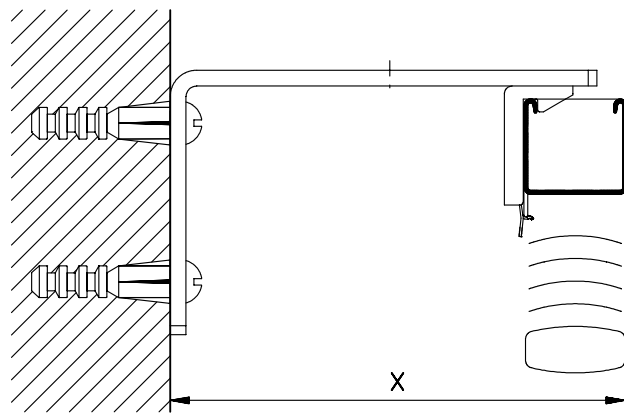
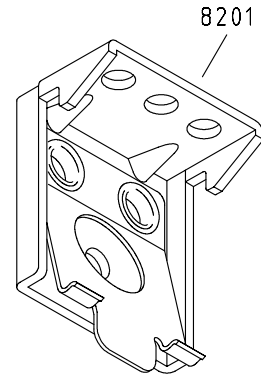
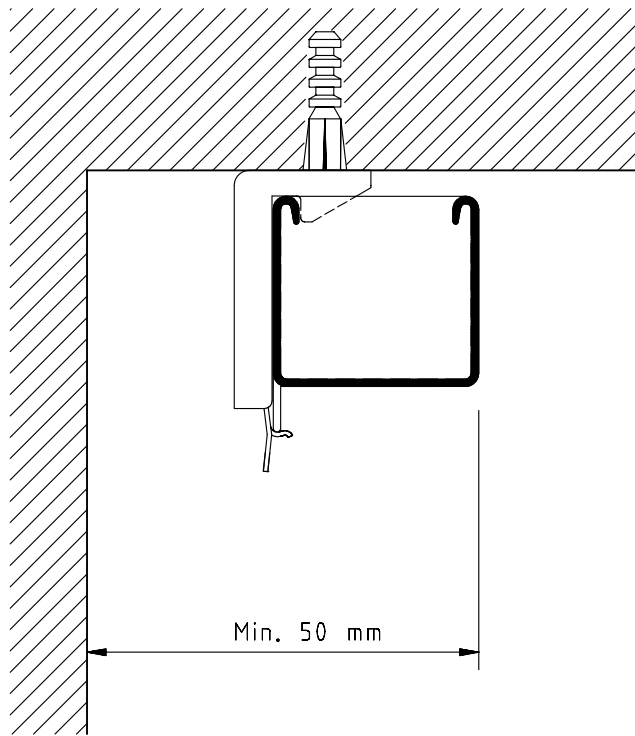

Winkel/Bracket	Y	X
3134	-	75 mm
3135	45 mm	95 mm
3136	65 mm	115 mm
3137	85 mm	135 mm

ANSCHLUSSSCHEMA
WIRING DIAGRAM

-42-

