

Ansicht von Innen

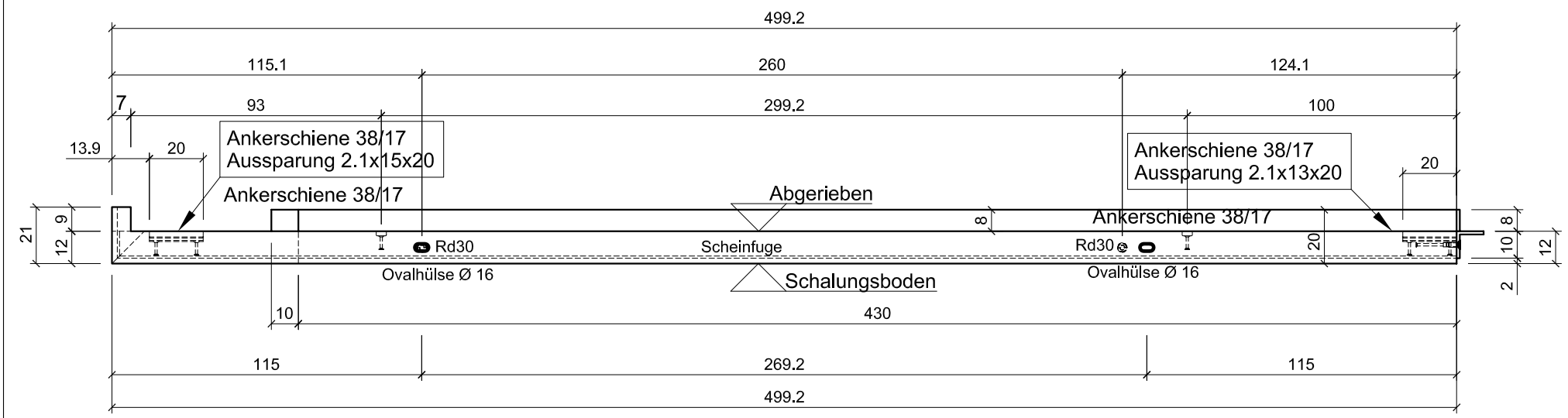

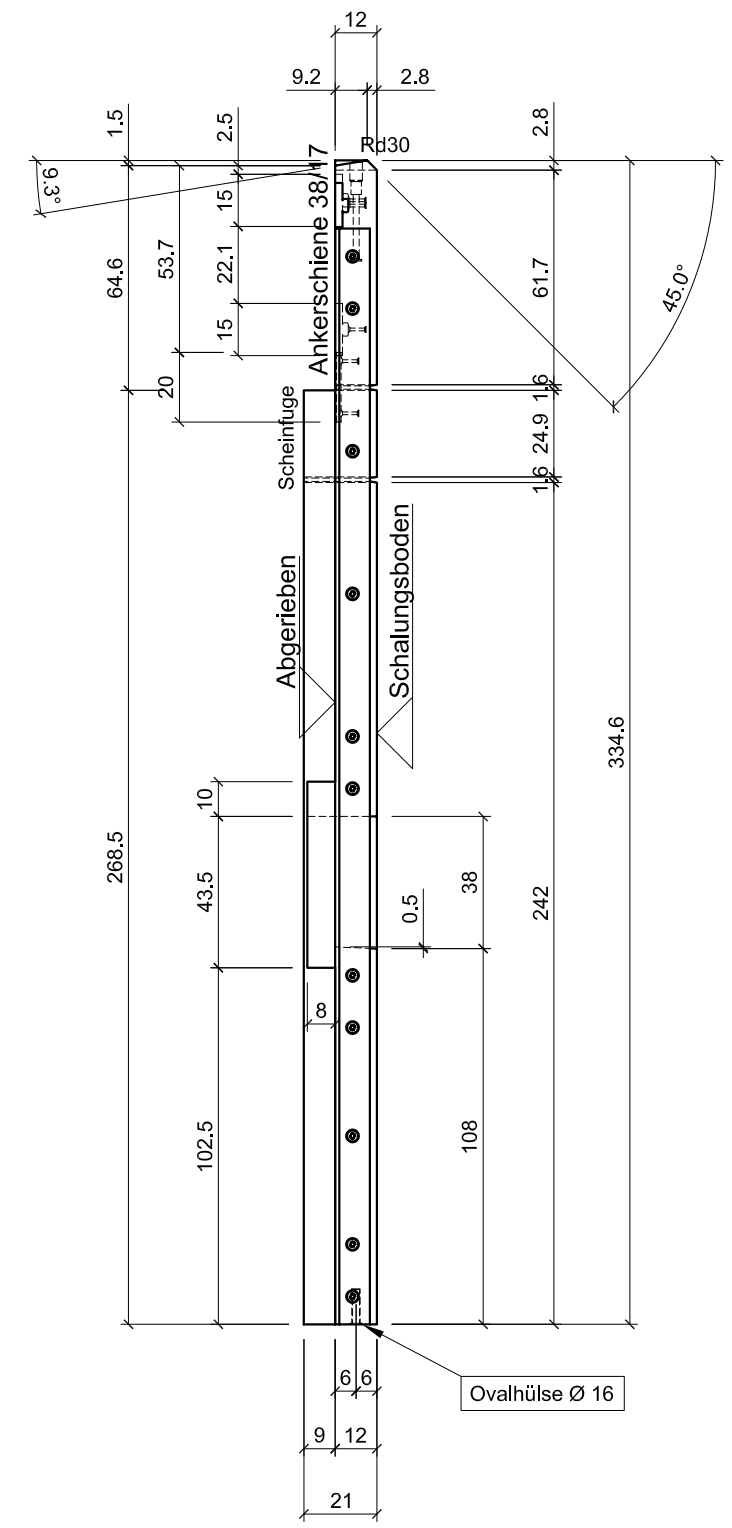

WILHELM + MAYER
 Fa. Wilhelm + Mayer
 Gesellschaft
 m.b.H.&Co.KG
 A-6833 Klaus, Erlenstr. 2
 Tel. 05523/52120
 Fax 05523/52120 - 5
 e-mail:
 wm@wilhelm-mayer.at

WA "Oberes Tobel" in Götzis
 Fassadenplatte Ansicht a Pos. a-06
 Gesamt 1 Stk.
 F= 16.51 m², V= 1.86 m³, G= 4700 kg
 Baunummer 1811
 Beton C35/45, B2, GK16, F38
 Betondeckung aussen 3.0 - innen 2.0
 Oberfläche schalglatt Sichtbeton
 Einfüllseite abgerieben

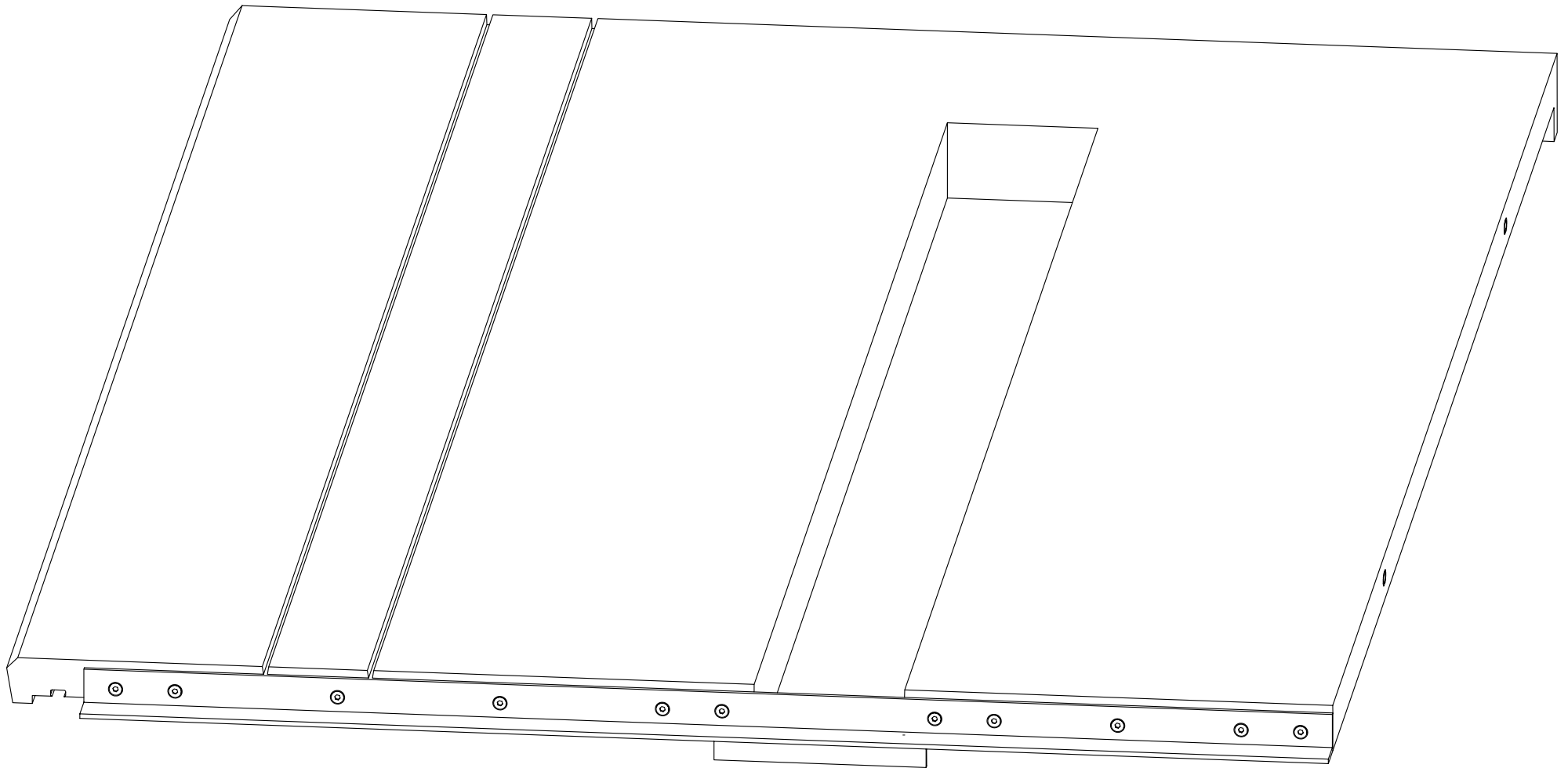
Ansicht auf Stahlwinkel

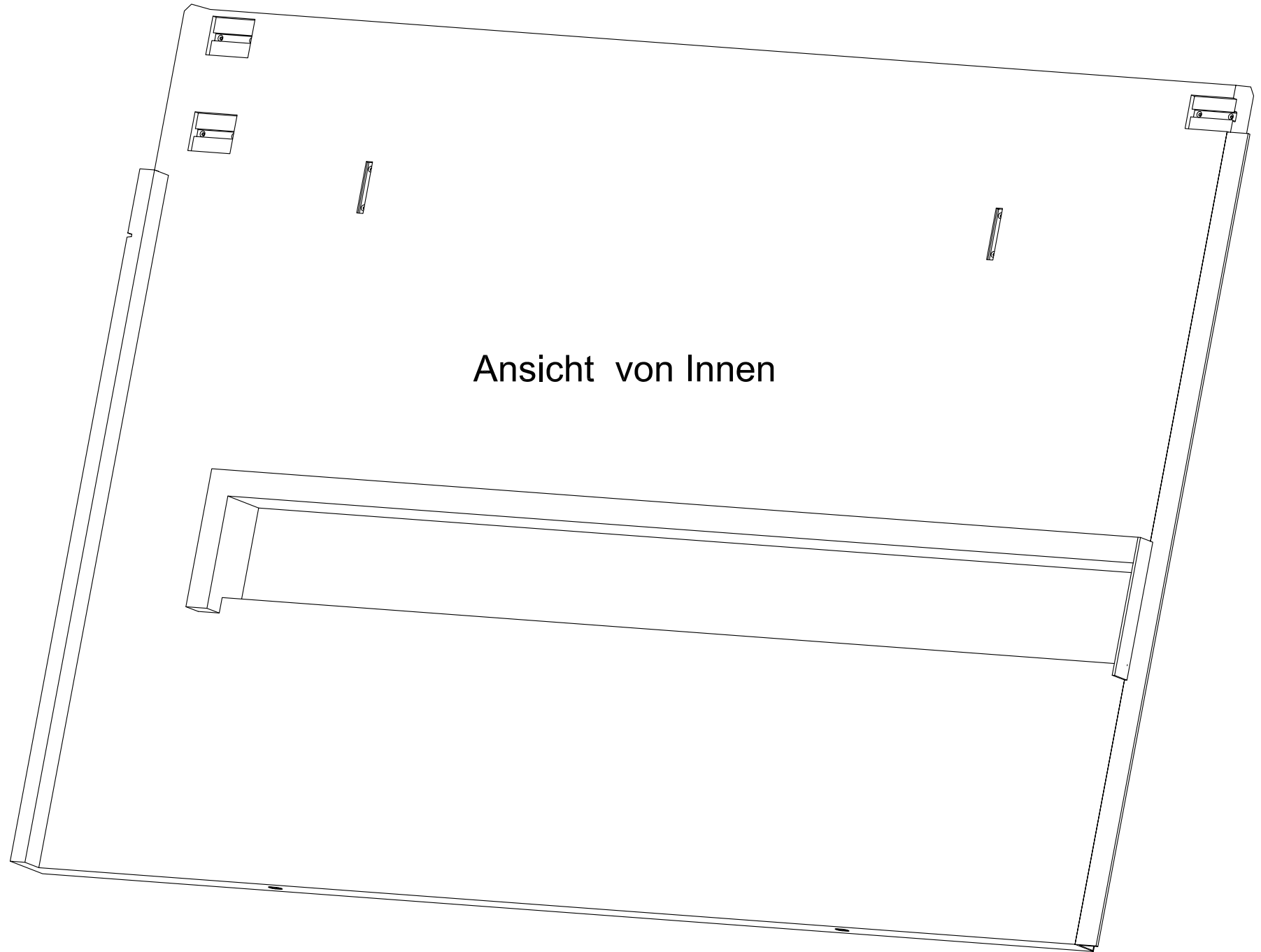



Ansicht von Innen

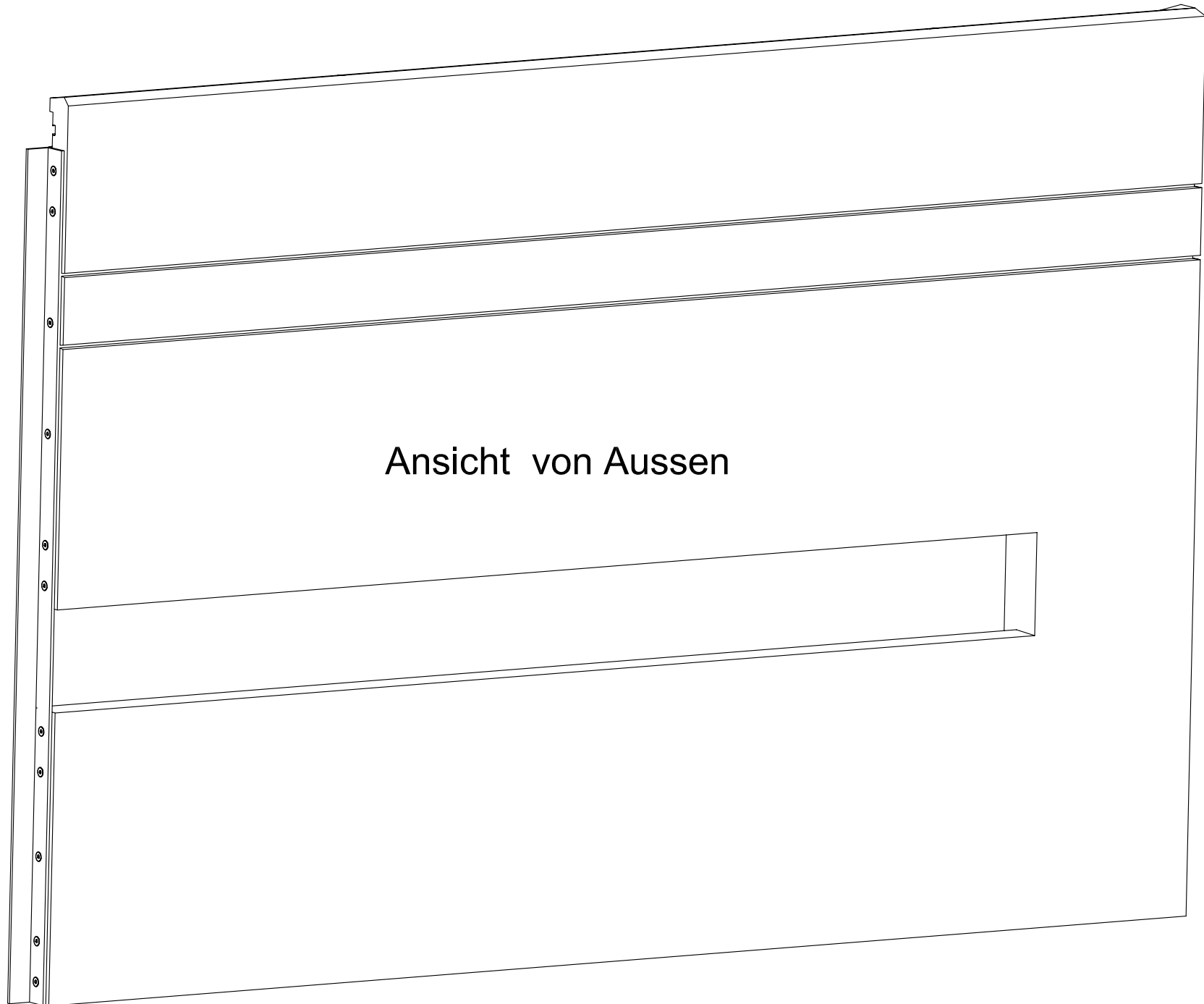

Ansicht von Aussen

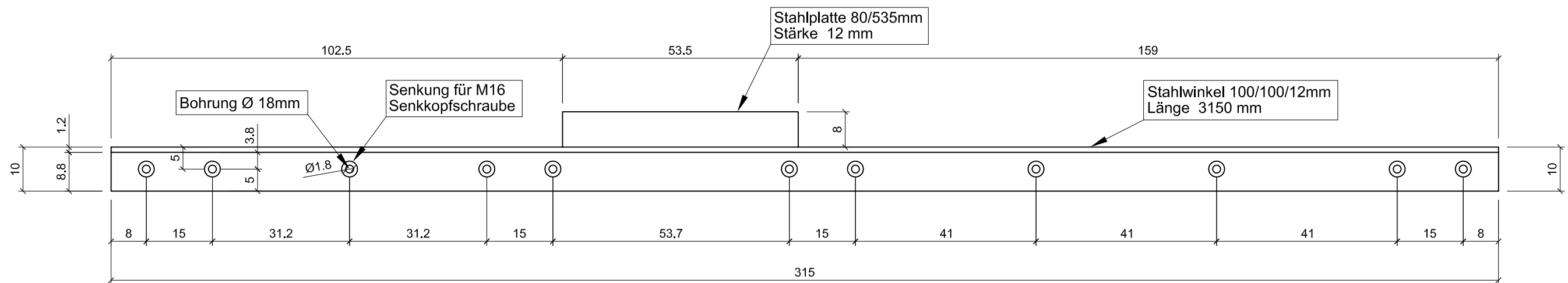
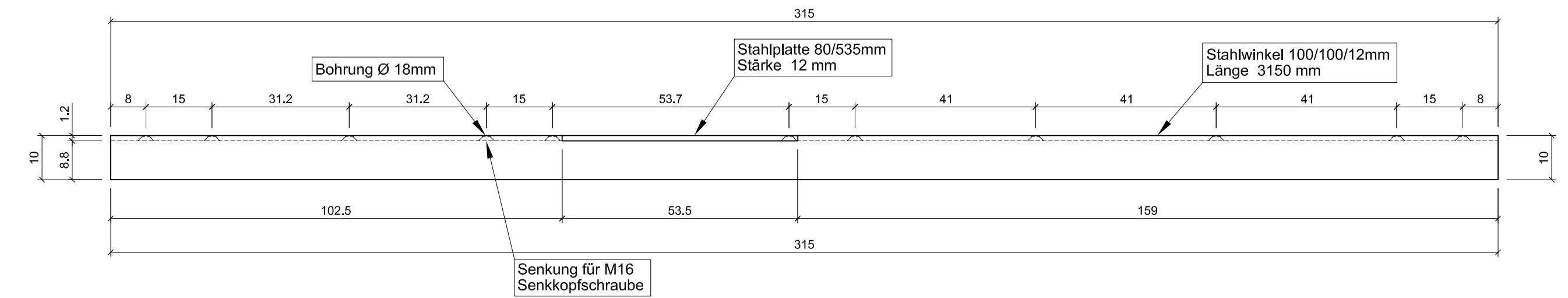

Schnitt

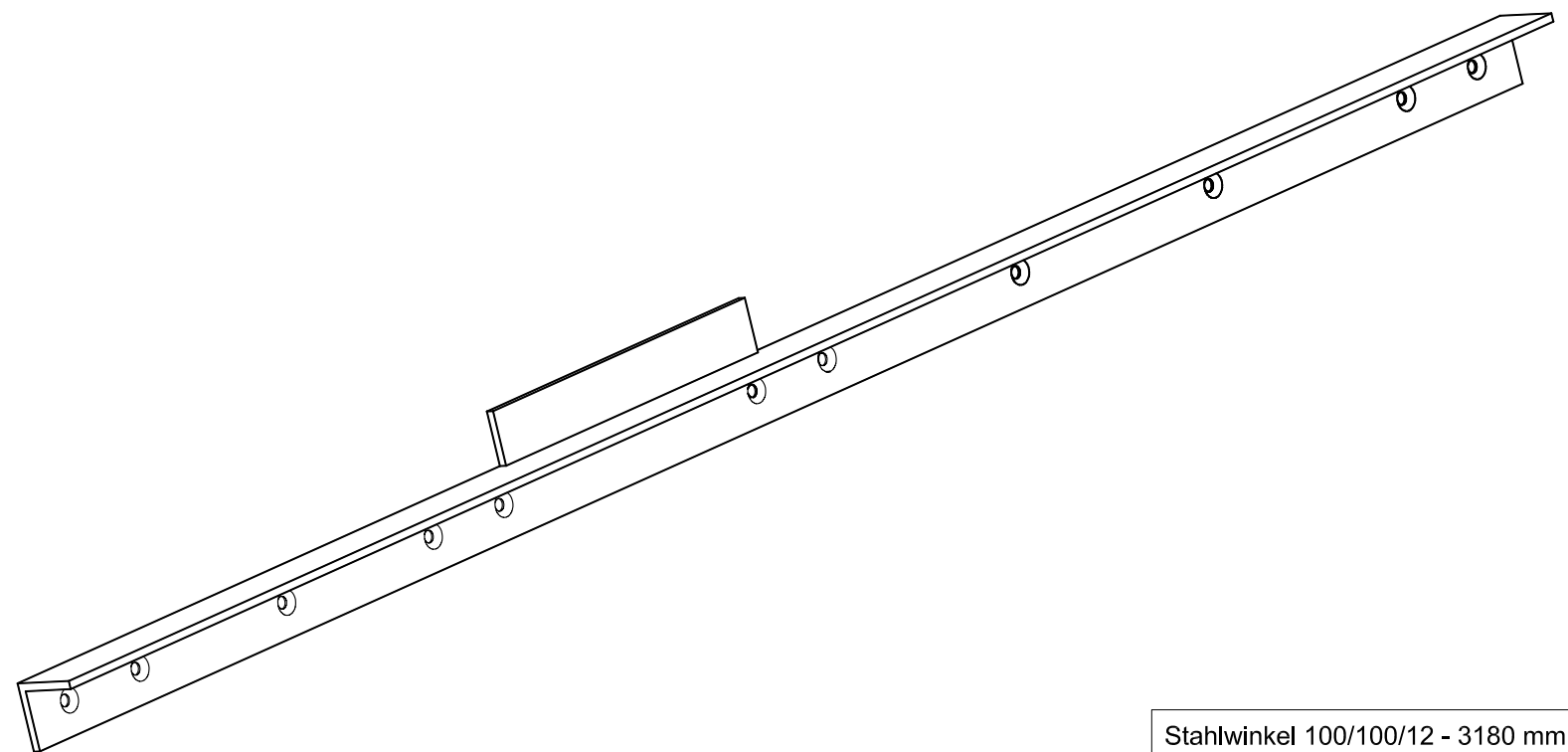
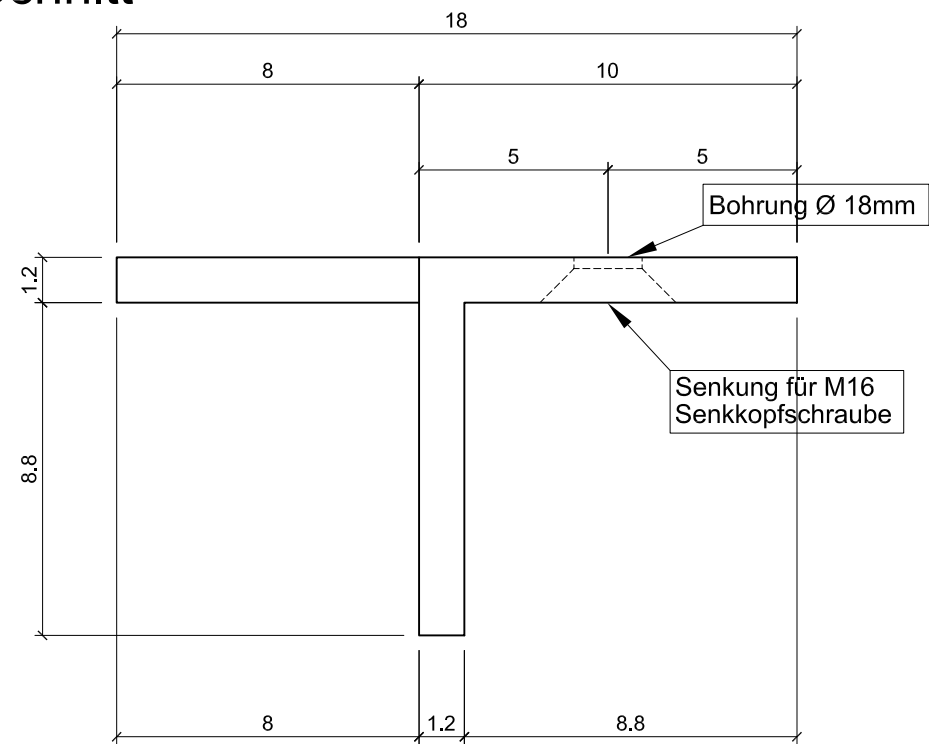

Achtung Maße in cm

Stahlwinkel 100/100/12 - 3180 mm lang
 Gesamt 1 Stück Feuerverzinkt
 Gewicht pro Stück 59.29 kg
 BV WA " Oberes Tobel " in Götzis
 Baunummer: