

Kuchenzeichnung

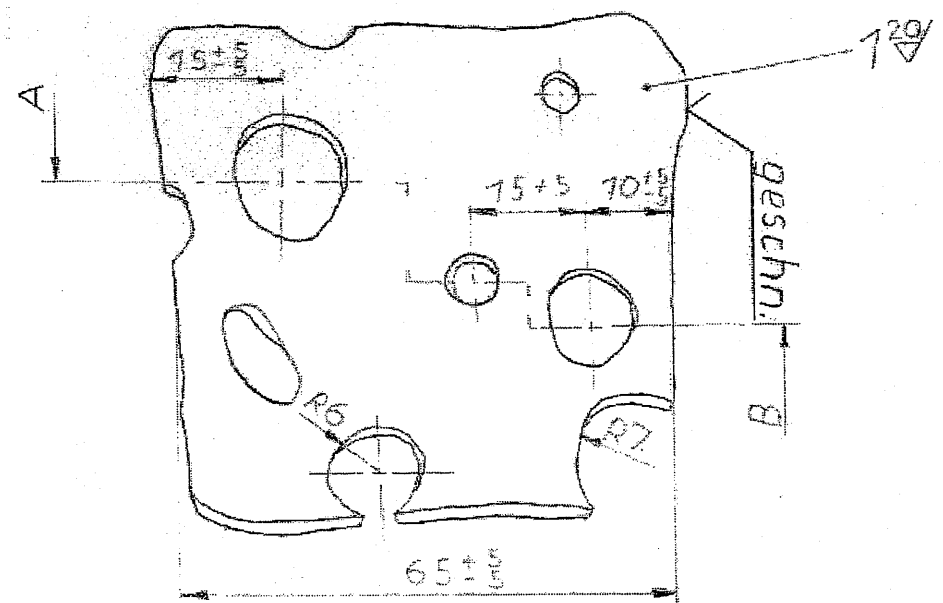

Aufschnitt A-B

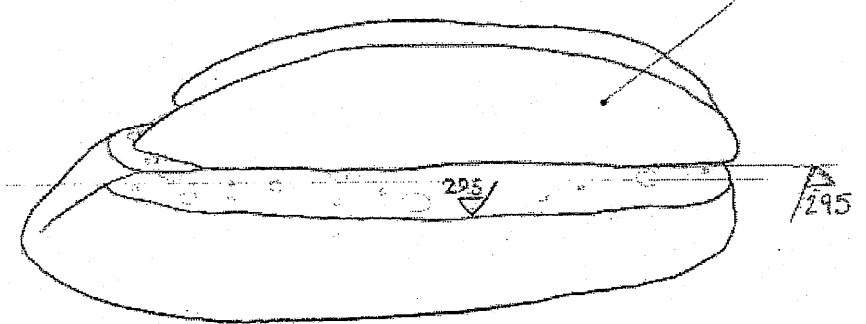

geputzt

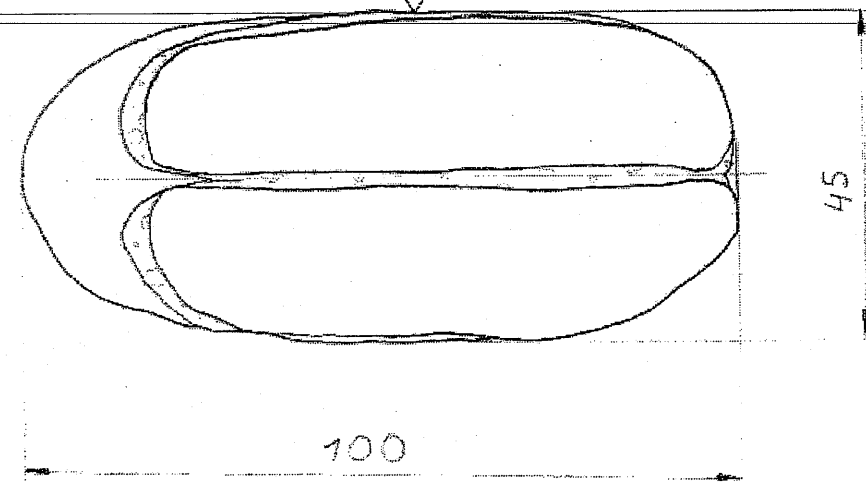

Menüzeichnung

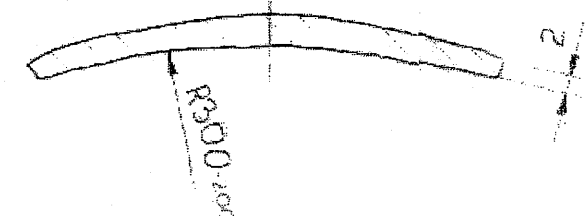
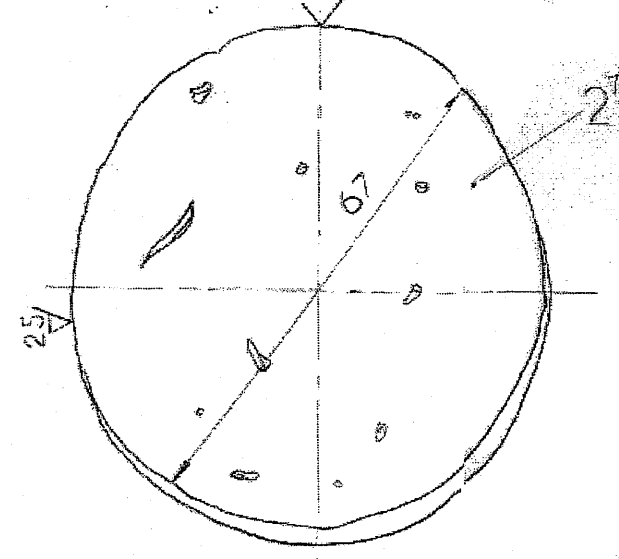

gebacken

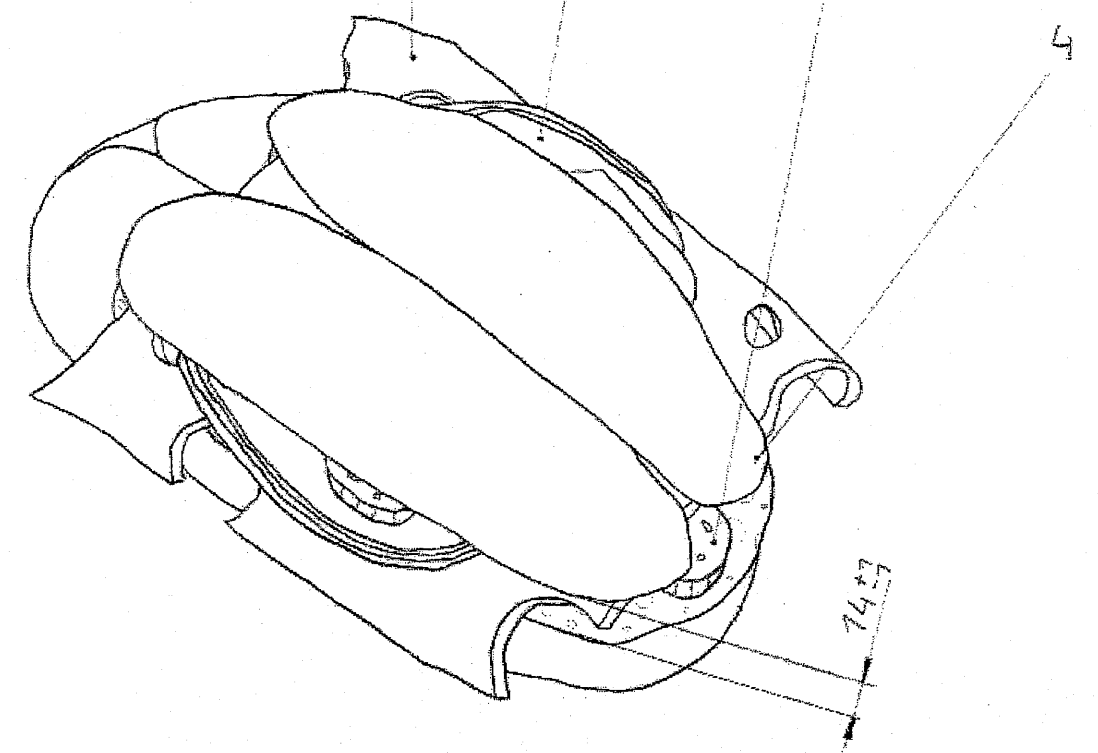
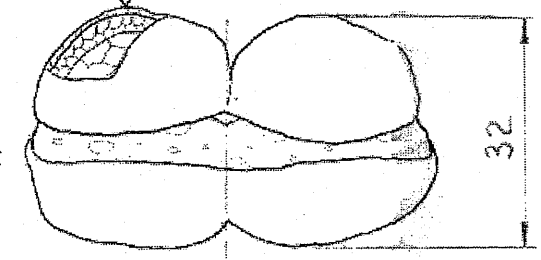

Schnittfl. d. Semmel mit Teebutter geschmiert

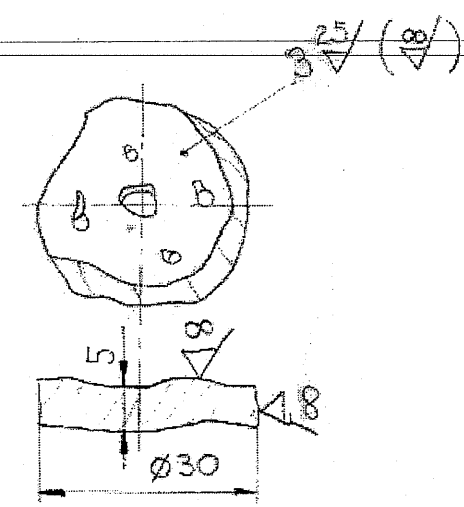

| 1   | Semmel              | 4    | Bock-N 1 | Teig      | ADEG-Sonderang     |
|-----|---------------------|------|----------|-----------|--------------------|
| 3   | Gurke               | 3    | Nat-N 53 | Organisch | Garten gedüngt     |
| 3   | Extrawurst (Pikant) | 2    | Fleisch  | 4 Augen   | Affe, blind-Lebend |
| 1   | Emmentaler          | 1    | Kuh-N 34 | Milch     | weiß 40% Fett      |
| Stk | Benennung           | Teil | Norm     | WSt.      | Bemerkungen        |

|                        |                              |              |              |  |                      |
|------------------------|------------------------------|--------------|--------------|--|----------------------|
| 20.6.1007              | Tag                          | Spitzname    | Husch Prusch |  | Die Harte Böhel Argh |
| Gez.                   | 99990                        | Martin Vidic | Murr & Co    |  |                      |
| Gepr.                  |                              |              |              |  |                      |
| N. Gepr.               |                              |              |              |  |                      |
| Maßst.                 |                              |              |              |  |                      |
| 11                     | Extrawurstsemmel (Kas, Gur.) |              |              |  | Letztes Progr. WSKU  |
| Geschmacksfol. exquis. |                              |              |              |  | Rezept 1             |
|                        |                              |              |              |  | Klasse 2M ORIGINAL   |

|        |         |          |
|--------|---------|----------|
| φ11H5  | φ11,008 | φ11,000  |
| φ7H5   | φ7,006  | φ7,000   |
| φ10H10 | φ10,058 | φ10,000  |
| PASS.  | Größtm. | Kleinst. |